

Post #1 Connection Detail

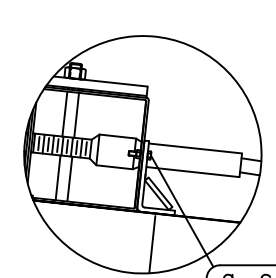

Impact Head Connection Detail

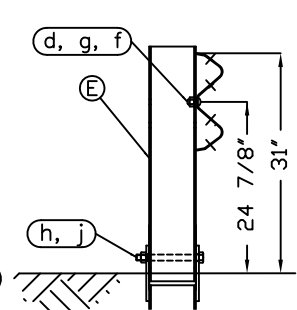

SECTION A-A  
Post #2

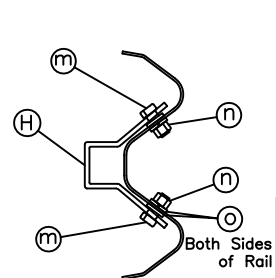

SECTION B-B  
Anchor Bracket

ITEM	QTY	BILL OF MATERIALS (TERMINAL)	ITEM NO.
A	1	IMPACT HEAD	F3000
B	1	W-BEAM GUARDRAIL END SECTION, 12 Ga.	SF1303
C	1	FIRST POST TOP (6x6x $\frac{1}{4}$ " Tube)	TPHP1A
D	1	FIRST POST BOTTOM (6' W6X15)	TPHP1B
E	1	SECOND POST ASSEMBLY TOP	UHP2A
F	1	SECOND POST ASSEMBLY BOTTOM	HP3B
G	1	BEARING PLATE	E750
H	1	CABLE ANCHOR BOX	S760
J	1	BCT CABLE ANCHOR ASSEMBLY	E770
K	1	BEARING PLATE RETAINER TIE	CT-100S
HARDWARE (ALL DIMENSIONS IN INCHES)			
a	2	5/16 x 1 HEX BOLT GRD 5	B5160104A
b	4	5/16 WASHER	W0516
c	2	5/16 HEX NUT	N0516
d	9	5/8 Dia. x 1 1/4 SPLICE BOLT	B580122
e	1	5/8 Dia. x 9 HEX BOLT GRD 5	B580904A
f	3	5/8 WASHER	W050
g	10	5/8 Dia. H.G.R NUT	N050
h	1	3/4 Dia. x 8 1/2 HEX BOLT GRD A449	B340854A
j	1	3/4 Dia. HEX NUT	N030
k	2	1 ANCHOR CABLE HEX NUT	N100
l	2	1 ANCHOR CABLE WASHER	W100
m	8	CABLE ANCHOR BOX SHOULDER BOLT	SB58A
n	8	1/2 A325 STRUCTURAL NUT	N055A
o	16	1 1/16 OD x 9/16 ID A325 STR. WASHER	W050A

- GENERAL NOTES:
- All bolts, nuts, cable assemblies, cable anchors and bearing plates shall be galvanized.
  - The lower sections of the Posts 1&2 shall not protrude more than 4 in above the ground (measured along a 5' cord). Site grading may be necessary to meet this requirement.
  - The lower sections of the hinged posts should not be driven with the upper post attached. If the post is placed in a drilled hole, the backfill material must be satisfactorily compacted to prevent settlement.
  - When competent rock is encountered, a 12"  $\varnothing$  post hole, 20 in. deep cored into the rock surface may be used if approved by the engineer for post 1. Granular material will be placed in the bottom of the hole, approximately 2.5" deep to provide drainage. The first post can be field cut to length, placed in the hole and backfilled with suitable backfill. The soil plate may be trimmed if required.
  - The breakaway cable assembly must be taut. A locking device (vice grips or channel lock pliers) should be used to prevent the cable from twisting when tightening nuts.
  - Additional components required downstream of terminal (see plan for required w-beam rail sections):

QTY	Desc.	Item#
8	5/8" x 1 1/4" Splice Bolt	B580122
13	5/8" Dia. H.G.R. Nut	N030
5	6x9 Steel Post	P621
5	MGS Block	P618
5	5/8" x 14" H.G.R. Bolt	B581402

**RSI**  
Road Systems, Inc.  
Big Spring, TX  
Sales: 432-263-2435  
Technical: 330-346-0721

FLEAT-SP-MGS Terminal  
Midwest Guardrail System  
31" Top of Rail

Sheet: 1  
Date: 01/15/12  
By: JRR  
Rev: 0

Drawing Name: FLT-SP-S-MGS  
Scale: None